

# Installing the Danalock on a door with a Euro cylinder

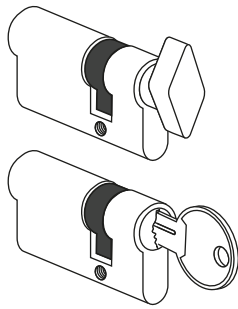

To mount the Danalock on a door with an euro cylinder you will have to exchange it.

The cylinder could look like the ones to the left, or it could be a completely different model, these illustrations are just examples.

First you have to order a new cylinder with your Danalock.  
To find out what size of cylinder to order, follow these steps:

**1.** Dismount you existing cylinder.  
You do this by unscrewing the screw in the door that holds the cylinder.

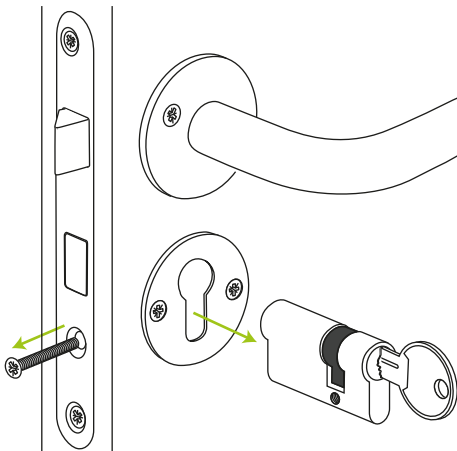

**2.** Now you will have to measure the cylinder. You measure the cylinder as shown here:

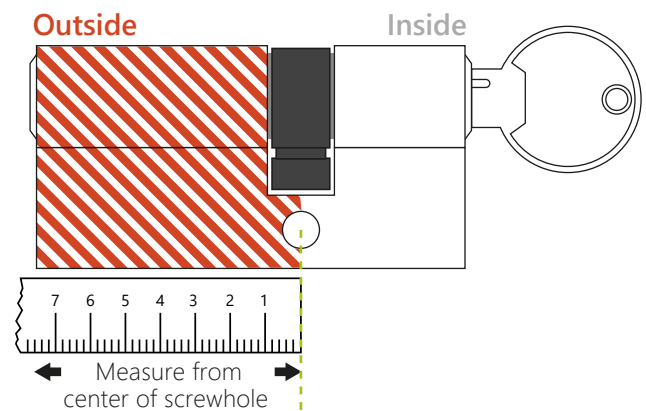

**3.** Choose the cylinder in our web shop that comes closest to your existing cylinder

Choose one of these fixed sizes:

- 25 x 30 mm
- 30 x 40 mm
- 30 x 45 mm
- 30 x 50 mm

**4.** Follow the mounting guide in the Danalock package or on our website [danalock.com/danalock-v3-euro-guide](http://danalock.com/danalock-v3-euro-guide) to mount the Danalock on your door.